

# Information Night on Enrolment Killina Presentation 2024-25



# You are all very welcome and thanks for taking the time to join us

- School context
- How the school is organised
- What is expected of a Killina student
- Transfer to secondary school
- Important policies
- Subject Choice
- Enrolment procedure

# History

- 1812 School founded
- 1817 Primary School, Presentation sisters
- 1948 Secondary School Top
- 1965 School moves to Co Education
- 1977 Full Secondary School status
- 90's Growth in student numbers
- 2001 Resource centre opened
- 2009, 2018 Extensions added
- 2024 Phase 1  
Phase 2 being planned

# CEIST Charter

- **Trustees- CEIST**

## *Promoting Spiritual and Human Development*

We believe a knowledge of and a personal relationship with Jesus Christ give meaning and purpose to our lives.

## *Achieving Quality in Teaching and Learning*

We are committed to excellence and to continually improving the quality of teaching and learning.

## *Showing Respect for Every Person*

We respect the unique and intrinsic value of every person.

## *Creating Community*

Our schools are faith communities of welcome and hospitality where Gospel values are lived and where there is special care for those most in need.

## *Being Just and Responsible*

We seek to act justly and responsibly in all our relationships.

# Killina Presentation

- All round education – holistic approach
- Quality of Relationships
- Pupil involvement – extra curricular-co curricular-student leadership
- Excellent atmosphere
  - good place to be- in good company
  - a caring environment- structures that ensure this
- Formation – mature young men and women with high personal standards-that can achieve
- Co-educational -Knowledge, Attitudes and Dispositions
- A thriving and growing school

# Why choose Killina Presentation

- The only co-educational Voluntary Secondary School in the area. (Faith based)
- Boys and girls taught together.
- A healthy mix of town and country.
- A country setting and caring environment. – the largest secondary campus in Offaly.
- A hard working and dedicated staff.
- Excellent record of academic achievement.
- Comprehensive extra curricular activities.
- A broad and well balanced curriculum.
  - J. Cycle, TY, L. Cert, LCVP, LCA.

- A full and busy timetable.
- All students remain on campus throughout the day.
- Hot meals at lunchtime.
- All the facilities needed to deliver.
- Plans for improvements to the school.
- An inclusive school.
- A progressive school. – we adapt to suit students needs
- A caring school where students can be happy and achieve.

# ESRI Research

## ‘EMBRACING DIVERSITY IN ALL ITS FORMS’: THE VOLUNTARY SECONDARY SECTOR IN IRISH EDUCATION

### EXECUTIVE SUMMARY

EAMONN CARROLL, SELINA MCCOY AND KEYU YE

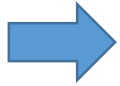

In terms of **school gender mix**, historical data indicate an increase in the percentage of students attending coeducational schools. Students, regardless of attending single-sex or coeducational schools, favoured coeducational settings, while preferences varied among staff and parents. Although some students believed their school’s gender mix supported their learning and preparedness for the future, fewer than 20% of respondents in single-sex schools preferred their school’s gender mix, compared to almost 90% in coeducational schools.

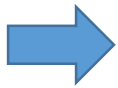

The scale of the preference expressed by students for coeducation was a surprise, with only a small minority of students in single-sex schools actively preferring their current school gender mix. One issue that came to the fore in our conversations with students, and in the survey data, related to participation in sports among girls, particularly girls in coeducational settings. Students in some (but not all) coeducational schools highlighted a hierarchy of opportunity, with boys’ sports taking centre stage. A dominance of male-orientated sport in coeducational settings has also been found in other countries and is explicitly acknowledged in the European Commission’s Gender Equality in Sport statement. There is a clear need to promote gender equality in sport, including school-based sport.



# School Organisation

- Principal & Deputy Principals
- Year Heads
- Chaplin
- Student support team
- Form Teachers – subject teachers
- Guidance/ Counselling Team
- Dedicated teachers and SNAs
- Learning Support/ special education Team
- Resource Centre- ModGLD
- Nagle Centre- ASD
- Student Council
- Ancillary staff
- Mentors

# Promoting Positive Behaviour

- Respect for people
- Respect for property
- Application to work
- Firm and fair approach
- Creating excellent relationships
- Excellent leadership and example
- Catching the students doing good and applauding them

# Promoting Positive Behaviour

- Creating a CARING environment is very important to us.
- Students will often forget what we taught them but they will never forget how we made them feel.
- Relationships matter.
- If children are happy, they can learn.

# Important Policies

- Code of Behaviour
- Internet usage
- Attendance and participation
- Child Protection
- Anti-Bullying – make sure to tell and encourage your son/ daughter to let us know what is happening.



# Subjects on Offer

1 <sup>st</sup> Year		2 <sup>nd</sup> and 3 <sup>rd</sup> Year	
1	English	1	English
2	Irish	2	Irish
3	Maths	3	Maths
4	Religion	4	Religion
5	Geography	5	Geography
6	History	6	History
7	Science		
8	<b>Choose FOUR options from</b>	7	<b>Choose FOUR options from</b>
9	Business, Home Economics,	8	Science, Business, Home Economics,
10	Tech Graphics, French, Wood Technology,	9	Tech Graphics, French, Wood Technology,
11	Music, Visual Art, German, Spanish, Polish	10	Music, Visual Art, German, Spanish. Polish
	WELLBEING (non examination)		WELLBEING (non examination)
	CSPE		CSPE
	SPHE		PE
	PE		SPHE
	Guidance		Guidance

# Senior Cycle subject options

<b>English</b>	<b>Music</b>
<b>Irish</b>	<b>Art</b>
<b>Maths / Applied Maths</b>	<b>French</b>
<b>Polish</b>	<b>Spanish</b>
<b>Physics</b>	<b>German</b>
<b>Geography</b>	<b>Biology</b>
<b>History</b>	<b>Ag Science</b>
<b>Chemistry</b>	<b>Accounting</b>
<b>Business</b>	<b>LCVP</b>
<b>Home Economics</b>	<b>Economics</b>
<b>DCG</b>	<b>Religion (Examinable/ non examinable)</b>
<b>Construction Studies</b>	<b>LCPE (Examinable/non examinable)</b>

# Transfer Programme

- A detailed consultation with 6<sup>th</sup> class teachers
- Educational Passports (6<sup>th</sup> Class to 1<sup>st</sup> Year)
- CAT tests
- Making the transition as easy as possible for the students

# Transfer Programme

- Time to get to know their Form Teacher and Mentors
- Time to learn the Rules & Routines of the school  
i.e. timetable, lockers, journal, study skills etc.
- Bonding day
- An opportunity to ask questions
- A time to make new friends
- A place where they feel safe and secure



# Transport to and From Killina

- Bus Eireann and a number of private operators
- Information on transport to and from the school is available from the school website.
- The routes served by the various bus operators is available from the school office and website.

# Development plans

## PHASE 2

- Residual accommodation, Technology room, Graphics room, Physical education lab, Full size Gym.
- Development of additional sports facilities (Pitches and ball courts)

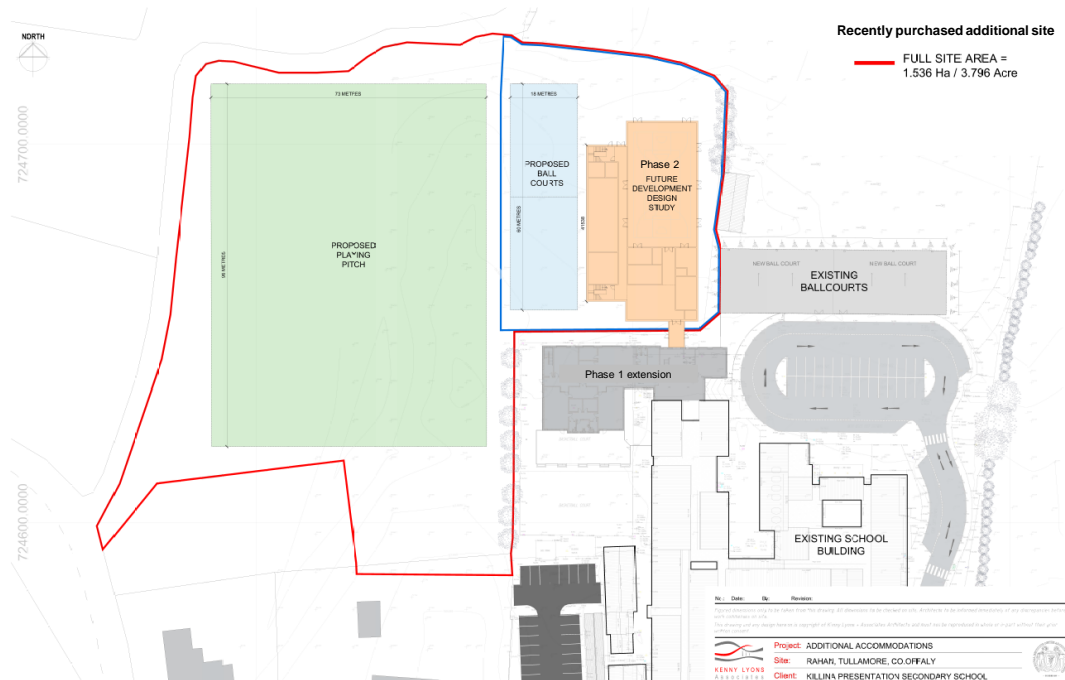

# Enrolment

- All in keeping with new admissions legislation.
  - Admissions Policy and Enrolment application form is available online.
  - Annual admissions notice available online.
  - Admissions Policy is available online.

The school shall cease accepting applications for admission on	5pm Monday November 8 <sup>th</sup> 2024
The date by which applicants will be notified of the decision on their application is	Friday 22 <sup>nd</sup> November 2024
The period within which applicants must confirm acceptance of an offer of admission is	Friday 6 <sup>th</sup> December 2024

# How do you verify what I have said ?

Do your homework

- Talk to parents of students in our school.
- Talk to our students.
- Talk to our teachers.
- [www.education.ie](http://www.education.ie)
- [www.schoolsdays.ie](http://www.schoolsdays.ie)
- [www.killinaschool.ie](http://www.killinaschool.ie)
- School social media streams



Thank you